

INSTALLATION INSTRUCTIONS

PICTURES SHOWN ARE OF THE CHROME PARTS. INSTALLATION OF THE BLACK PARTS WILL BE THE SAME.

ENYGMA LEVERS 17-20 TOURING

10058-1 CHROME OR 10058-2 BLACK

THANK YOU FOR CHOOSING KURYAKYN!

Protect yourself and others from possible injury and property damage or loss. Pay close attention to all instructions, warnings, cautions, and notices regarding the installation, use, and care of this product.

WARNING THIS INDICATION ALERTS YOU TO THE FACT THAT IGNORING THE CONTENTS DESCRIBED HEREIN CAN RESULT IN POTENTIAL DEATH OR SERIOUS INJURY.

CAUTION THIS INDICATION ALERTS YOU TO THE FACT THAT IGNORING THE CONTENTS DESCRIBED HEREIN CAN RESULT IN MINOR OR MODERATE POTENTIAL INJURY.

NOTICE THIS INDICATION ALERTS YOU TO THE FACT THAT IGNORING THE CONTENTS DESCRIBED HEREIN MAY NEGATIVELY AFFECT PRODUCT PERFORMANCE AND FUNCTIONALITY OR DAMAGE THE PRODUCT ITSELF OR THE PRODUCT TO WHICH IT IS BEING ATTACHED.

ENSURE THAT THE FOLLOWING PARTS HAVE BEEN INCLUDED IN THE KIT:

- 1 Brake Lever
- 1 Clutch Lever

YOU WILL ALSO NEED:

Snap-ring pliers, needle-nose pliers, grease, Phillips screw driver

NOTICE THESE INSTALLATION INSTRUCTIONS CONTAIN IMPORTANT INFORMATION. ENSURE THE END USER RECEIVES THIS COPY AND IS AWARE OF ITS IMPORTANCE FOR FUTURE USE.

STEP 1 Read and understand all steps in the instructions before starting the installation. Park the motorcycle on a hard, level surface and turn off the ignition. Let motorcycle cool. Remove main fuse.

WARNING A FACTORY SERVICE MANUAL WILL BE HELPFUL IN PERFORMING THIS INSTALLATION. DO NOT ATTEMPT TO PERFORM THIS INSTALLATION IF YOU ARE NOT CONFIDENT IN YOUR ABILITY TO COMPLETE ALL OF THE STEPS IN THE PROCEDURE; CONSULT A TRAINED TECHNICIAN. IMPROPER INSTALLATION COULD RESULT IN SERIOUS INJURY OR DEATH.

WARNING ACCIDENTAL VEHICLE START-UP COULD CAUSE DEATH OR SERIOUS INJURY, REMOVE THE MAIN FUSE BEFORE PROCEEDING.

NOTICE AVOID DAMAGE TO THE MOTORCYCLE. PROTECT PAINTED SURFACES WITH A SOFT CLOTH OR BLANKET.

CLUTCH SIDE

- STEP 2** Refer to **PIC 3**. Remove the snap-ring securing the clutch lever pivot-pin in the perch assembly; save it for later.
- STEP 4** Loosen the screws securing the clutch (left-side) handlebar switch housing assembly.
- STEP 5** With the clutch housing/lever assembly loosened from the handlebar, remove the pivot pin and lever; set the pivot pin aside, it will be reused.
- STEP 5** Refer to **PIC 4**. Carefully remove the existing clutch lever.

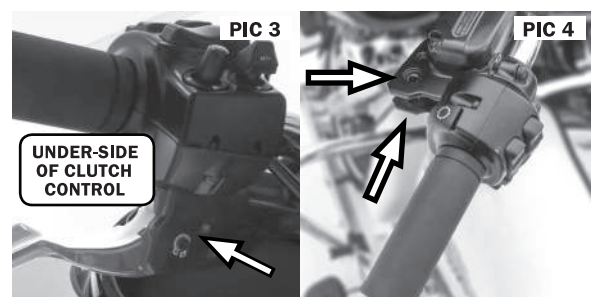
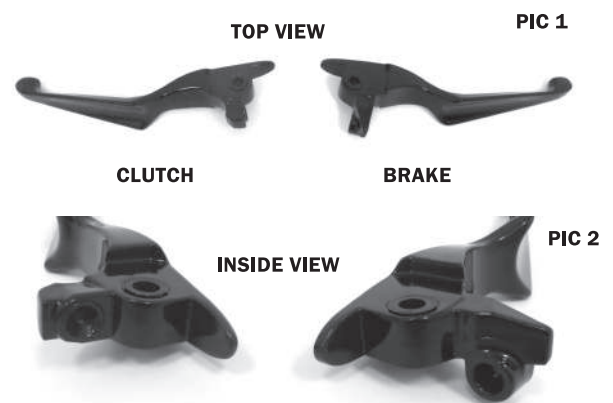

KURYAKYN.COM

267-468-0350 ext 8100 | info@kuryakyn.com

100 Tournament Dr. Horsham, Pa. 19044

INSTAGRAM/FACEBOOK: @KURYAKYN

INSTALLATION INSTRUCTIONS

ENYGMAL LEVERS 17-20 TOURING

10058-1 CHROME OR 10058-2 BLACK

-CONTINUED-

- STEP 6** Refer to **PIC 5**. Ensure that the plastic bushing stays flush as the new Clutch Lever is installed; ensure that the clutch plunger is pressed in and does not bind as the new Lever is installed.

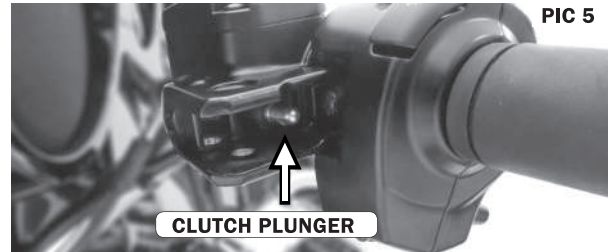

- STEP 7** Refer to **PIC 6** and **PIC 7**. Reinstall the pivot pin and secure with the snap-ring. Tighten the clutch (left) side handlebar switch housing assembly screws. Compress the Clutch Lever a few times to ensure that the clutch works properly BEFORE starting the motorcycle.

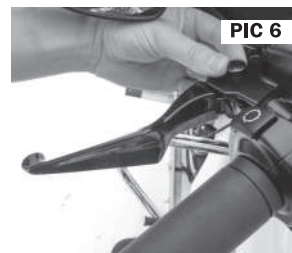

BRAKE SIDE

- STEP 8** Remove the snap-ring securing the brake lever pivot-pin in the perch assembly; set it aside for now it will be reused.
- STEP 9** Refer to **PIC 8**. Loosen the screws securing the brake (right-side) handlebar switch housing assembly.
- STEP 10** With the master cylinder/lever assembly loosened from the handlebar, remove the pivot pin and lever; set the pivot pin aside, it will be reused.
- STEP 11** Refer to **PIC 9** and **PIC 10**. Ensure that the plastic bushing stays flush as the new Brake Lever is installed; ensure that the brake switch and brake plunger are compressed as the lever is installed.

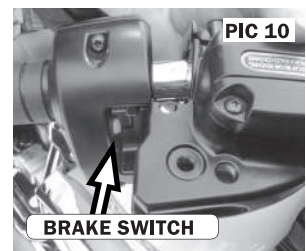
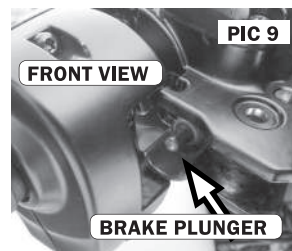
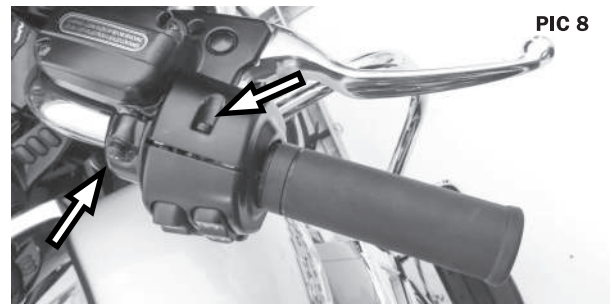

- STEP 12** Reinstall the pivot pin and secure with the snap-ring. Tighten the brake (right) side handlebar switch housing assembly screws. Compress the Brake Lever a few times to ensure that the brakes work properly BEFORE starting the motorcycle.

NOTICE

IT IS THE INSTALLER'S RESPONSIBILITY TO ENSURE THAT ALL OF THE FASTENERS (INCLUDING PRE-ASSEMBLED) ARE TIGHTENED BEFORE OPERATION OF THE MOTORCYCLE. KURYAKYN WILL NOT PROVIDE WARRANTY COVERAGE ON PRODUCTS OR COMPONENTS LOST DUE TO IMPROPER INSTALLATION OR LACK OF MAINTENANCE. PERIODIC INSPECTION AND MAINTENANCE ARE REQUIRED ON ALL FASTENERS.



KURYAKYN.COM

267-468-0350 ext 8100 | info@kuryakyn.com

100 Tournament Dr. Horsham, Pa. 19044

INSTAGRAM/FACEBOOK: @KURYAKYN



INSTALLATION INSTRUCTIONS

ENYGMA LEVERS 17-20 TOURING

10058-1 CHROME OR 10058-2 BLACK

-CONTINUED-

LIMITED WARRANTY

Kuryakyn warrants that any Kuryakyn products sold hereunder, shall be free of defects in materials & workmanship for a period of one (1) year from the date of purchase by the consumer excepting the following provisions:

1. Kuryakyn shall have no obligation in the event the customer is unable to provide a receipt showing the date the customer purchased the product(s).
2. The product must be properly installed, maintained & operated under normal conditions.
3. Kuryakyn shall not be liable for any consequential & incidental damages, including labor & paint, resulting from failure of a Kuryakyn product, failure to deliver, delay in delivery, delivery in nonconforming condition, or for any breach of contract or duty between Kuryakyn & a customer.
4. Kuryakyn products are often intended for use in specific applications. Kuryakyn makes no warranty if a Kuryakyn product is used in applications other than intended.
5. Kuryakyn electrical products are warranted for one (1) year from the date of purchase by the consumer.
6. All warranty claims must be directed to the place of purchase. Merchandise sold through internet auction sites or any other unauthorized reseller shall not carry a Kuryakyn warranty. If unsure, please contact the place of purchase to verify they are an authorized Kuryakyn reseller.

RETURN POLICY

Merchandise determined to be defective may be returned up to one year from the date of purchase. Returns must be processed through original seller. Returned merchandise for any other reason other than warranty claims must be in like new condition & subject to a restocking fee. All returns are subject to inspection for determination of full or partial credit. Any returned part that shows evidence of being used or installed contrary to manufacturer's instructions, &/or subjected to improper handling, packaging or return shipping by the customer, will not be eligible for exchange, refund or warranty consideration. All returned electrical items will be inspected & tested. If electrical item is deemed functional, no credit will be issued & item will be returned. All sales are final on discontinued or closeout merchandise.

©2024 KURYAKYN HOLDINGS, LLC ALL RIGHTS RESERVED

KURYAKYN, KURYAKYN K logo and the marks appearing on this instruction sheet are registered and common law trademarks of Kuryakyn Holdings except noted third-party trademarks. A full listing of trademarks and trademark registrations owned by Kuryakyn Holdings can be found at www.kuryakyn.com/legal-notice. Emissions Notice: The California Air Resources Board (CARB) does not permit the use of aftermarket emission-related parts(s) that alter the performance of OEM emission-related devices unless CARB has issued an Executive Order, other than on racing vehicles on closed courses. Check your local laws and manufacturer's information. Listed Manufacturers and product model names are for reference only. All product and company names are trademarks or registered trademarks of their respective holders. Use of them does not imply any affiliation with or endorsement by them. All specifications are subject to change without notice.

KURYAKYN.COM

267-468-0350 ext 8100 | info@kuryakyn.com

100 Tournament Dr. Horsham, Pa. 19044

INSTAGRAM/FACEBOOK: @KURYAKYN